

Horizontal Plan Cabinet

A traditional plan chest suited to paper sizes A1 to A0.

Available in either 5 or 10 drawer models, Horizontal Plan Cabinets are suitable for storing thick or fragile items or in situations where attaching an adhesive strip is not appropriate. Available with optional castors or stand. Horizontal Plan Cabinets can be stacked two high. Available in 3 sheet sizes.

Manufacturer	Planex Sales Pty Ltd
Location	Hallam, Melbourne
Standard Warranty	Ten years

Horizontal Plan Dimensions

ISO A1	Height	Width	Depth
16-HA-5 (5 drawer)	470	950	650
16-HA-10 (10 drawer)	470	950	650

*A1 max sheet size 865 x 605

ISO B1	Height	Width	Depth
16-HB-5 (5 drawer)	470	1170	900
16-HB-10 (10 drawer)	470	1170	900

*B1 max sheet size 1085 x 850

ISO A0	Height	Width	Depth
16-HC-5 (5 drawer)	470	1295	900
16-HC-10 (10 drawer)	470	1295	900

*A0 max sheet size 1210 x 850

Accessories

Plan Cabinet Stand	Height	Width	Depth
16-HSA (A1)	300	960	660
16-HSB (B1)	300	1180	910
16-HSC (A0)	300	1305	910

Horizontal Plan Mobile Dimensions

ISO A1	Height	Width	Depth
16-HA-05-C100 (5 drawer)	605	950	650
16-HA-10-C100 (10 drawer)	605	950	650

ISO B2	Height	Width	Depth
16-HB-05-C100 (5 drawer)	605	1170	900
16-HB-10-C100 (10 drawer)	605	1170	900

ISO A0	Height	Width	Depth
16-HC-05-C100 (5 drawer)	605	1295	900
16-HC-10-C100 (10 drawer)	605	1295	900

Materials

- Welded body made of 100% recyclable BlueScope sheet steel (with 24.2% recycled content)

Colours/Finishes

- Standard powder coats available in 300+ colours/finishes

Product Features

- 5 drawer internal drawer height 50mm
- 10 drawer internal drawer height 25mm
- A full-width metal return at rear of the drawer prevents plans from being damaged or curling
- A chromed rod flap at the front of the drawer keeps plans flat

Manufacturing

- Made in Melbourne, Australia using locally sourced materials
- Manufactured for disassembly
- Polymer parts labelled for segregation and sorting
- Iron phosphate pre-treatment AS2331.3.1-2001 Method 3.1
- Planex factory uses a 100kW roof mounted solar array to provide up to 25% of manufacturing electricity needs

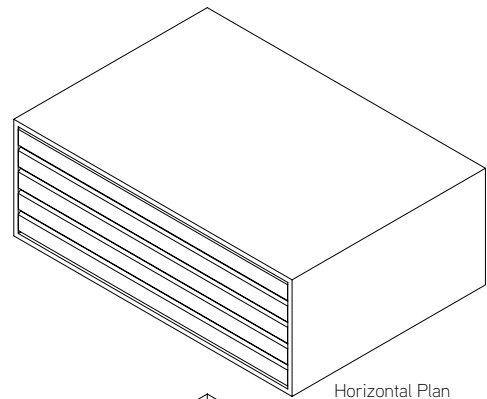

Horizontal Plan

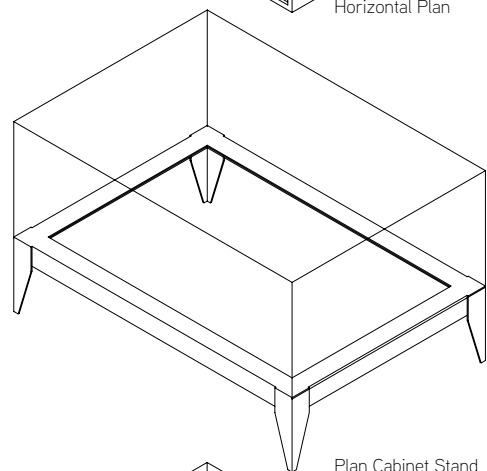

Plan Cabinet Stand

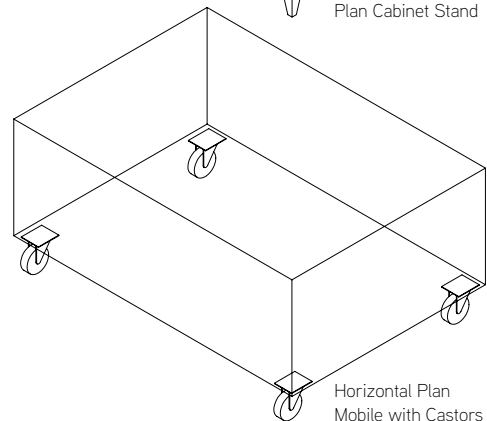

Horizontal Plan Mobile with Castors

Environmental Certification

- Product may contribute to Green Star credit points
- Production facility certified ISO14001 and ISO9001
- VOC compliant materials

Designed by Planex





Copyright Planex 2023

Information in this document may be
subject to change without notification

Head Office / Manufacturing

191 Princes Highway Hallam

VIC Australia 3803

PO Box 125 Hallam 3803

Tel: +61 3 8795 1100

Fax: +61 3 8795 1122

Email Head Office: info@planex.com.au

National Sales and Distribution

Adelaide

Brisbane

Canberra

Hobart

Perth

Sydney

Tel: +61 3 8795 1100

Email: info@planex.com.au

www.planex.com.au